



Chris Christie
Governor

Kim Guadagno
Lt. Governor

State of New Jersey

THE PINELANDS COMMISSION

PO Box 359

NEW LISBON, NJ 08064

(609) 894-7300

www.nj.gov/pinelands

General Information: Info@njpines.state.nj.us
Application Specific Information: AppInfo@njpines.state.nj.us



Mark S. Lohbauer
Chairman

Nancy Wittenberg
Executive Director

September 25, 2015

To: All Interested Bidders

Re: Solicitation # 16-101
Interpretive Exhibit Fabrication and Installation for the Pinelands Visitor Center

Addendum #1

The question period for #16-101 has been postponed and rescheduled for additional questions. All other instructions, terms and conditions of the RFP shall remain the same.

Proposal Question & Answer cutoff Date: September 24, 2015, 1:00 PM EST.
Revised Proposal Question & Answer Cutoff Date: September 29, 2015, 5:00 PM EST.

Addendum #2

An Addition to the Scope of Work for the Interpretive Exhibit Fabrication and Installation for the Pinelands Visitor Center.

Addendum #3

Floor Plan and Additional Photos

It is the sole responsibility of the bidder to be knowledgeable of all of the additions, deletions, clarifications and modifications to the RFP and/or the New Jersey Pinelands Terms and Conditions relative to the RFP as set forth in all Addenda.

Interested bidders are advised to monitor <http://www.nj.gov/pinelands/> for the Request for Proposal addenda for RFP #16-101 Interpretive Exhibit Fabrication and for the Pinelands Visitor Center Installation.

Signature Page of acknowledgment
For Addendums 1, 2, 3 to RFP-16-101

Date:

Business Name:

Print:

Signature:

Addendum #2 Addition to the Scope of Work:

In addition to carrying out all elements of the Exhibit Design Plan, the Contractor must complete all architectural improvements needed to convert the space into a Pinelands Visitor Center. If the Contractor proposes an alternative or substitute to achieving the same result as the plans for the architectural improvements described below, those proposals will be considered.

The Contractor must remove the existing flooring and furnish and install new marmoleum flooring throughout the Exhibit Space, which includes the exhibit room, lobby and the hallway leading to the bathrooms and kitchen (for a total of approximately 1,200 square feet of flooring). The Exhibit Space is shown in the enclosed document.

The Contractor is also responsible for painting all walls and ceilings in the exhibit space. The Contractor must widen the opening of the existing, 316-square-foot exhibit room to accommodate the new exhibits (opening the existing doorway to 9'-5" wide and 93" tall), as shown in the Exhibit Design Plan.

In addition, the Contractor must remove two existing windows on the interior library wall. The Contractor must hang drywall over the two windows. The Contractor also must relocate the doorway on the library (expanding it to 72" wide), as noted in the Exhibit Design Plan. The Contractor must install a double French door on the library, unless the Contractor identifies a suitable substitution. The French doors must be natural, clear- finished hardwood.

The Contractor must create a new receptionist's window (cutting the wall to 5'-wide, as shown in the attached Interior Enhancements document). The Contractor also must furnish and install a new desk for the receptionist. The existing receptionist desk will be discarded. The receptionist window will be trimmed with wood and will include a wooden ledge and a sliding glass window. The wooden trim and ledge must match the style of the lobby.

The Contractor must move the existing "founders/dedication plaque" from its current location, as shown in the Exhibit Design Plan.

Additionally, the Contractor must provide and install a new flat-panel, digital TV in the lobby. This TV must have networking capabilities and must be hardwired to the Pinelands Commission's network, with all power and network wires and connections hidden behind the walls and/or the TV. The TV will not be framed by the wooden tiles from the receptionist's desk. (This represents a change in the Exhibit Design Plan that is shown in item 7.3 of Book One).

The specific treatments (ie., colors and/or patterns or finishes) for the new flooring, walls and wood trim (around the new receptionist's window as well as the new wooden ledge for the receptionist's window) in the Exhibit Space will be determined by the Commission, in consultation with the selected Contractor.

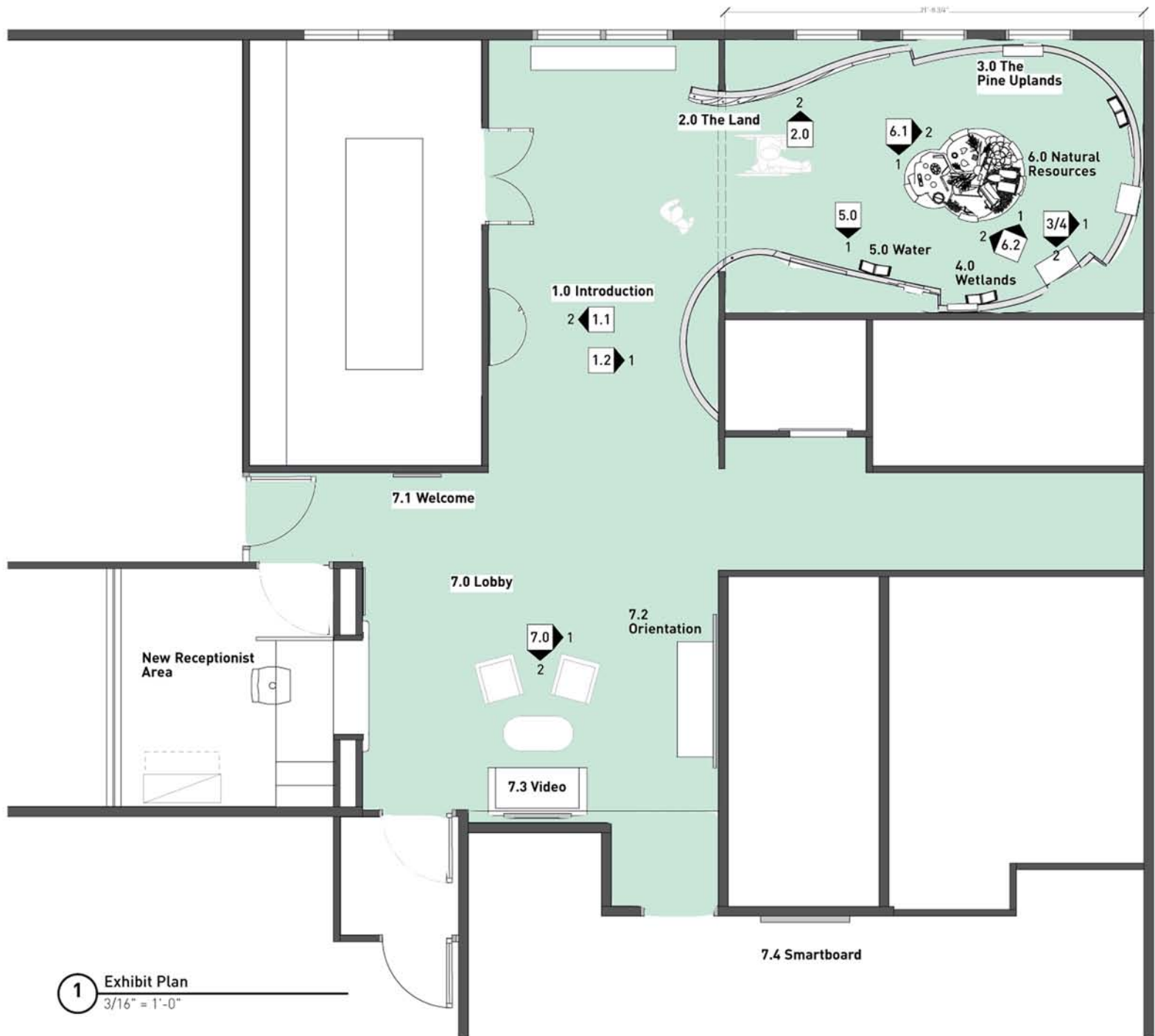

Elevation Key

- 1.1-2 Touchable Map
- 1.2-1 Flap Interactive Wall
- 2.0-1 The Land
- 3/4-1 The Pine Uplands
- 3/4-2 The Wetlands
- 5.0-1 Water
- 6.1-1 Natural Resources 1
- 6.1-2 Natural Resources 2
- 6.2-1 Natural Resources 3
- 6.2-2 Natural Resources 4
- 7.0-1 Graphic Panel
- 7.0-2 Screen

Key:

= Exhibit Space

***Note:**

The Contractor must install new flooring and must paint the walls and ceilings of the Exhibit Space.

1 Exhibit Plan
3/16" = 1'-0"



Written documents supersede verbal instructions. Contractors and fabricators shall verify & be responsible for verifying all dimensions and conditions on site and advise Content Design Collaborative of any discrepancy at drawings prior to performing the work.

This document represents design intent only. Contractors and fabricators shall comply with all local electrical, structural & safety codes. Content Design Collaborative LLC will NOT assume responsibility or liability for inappropriate engineering, construction, handling or installation of any components represented herein.

DATES ISSUED

- 8.30.11 Review
- 2.15.12 Task 3

Drawn by: SS

Title: Exhibit Plan

**Richard J. Sullivan Center for
Environmental Policy & Education**



Building Entrance

First Floor Blueprint

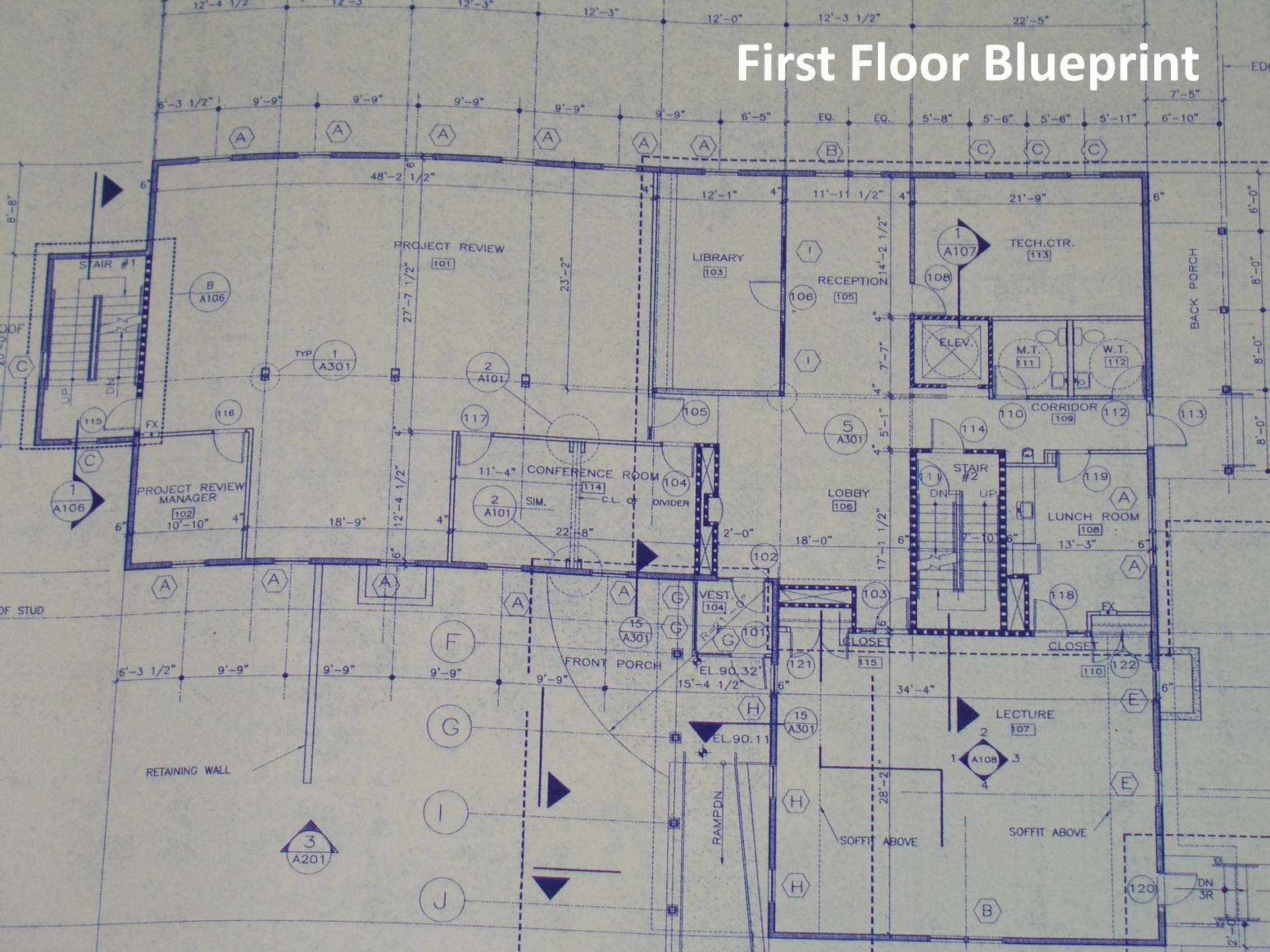

First Floor Blueprint

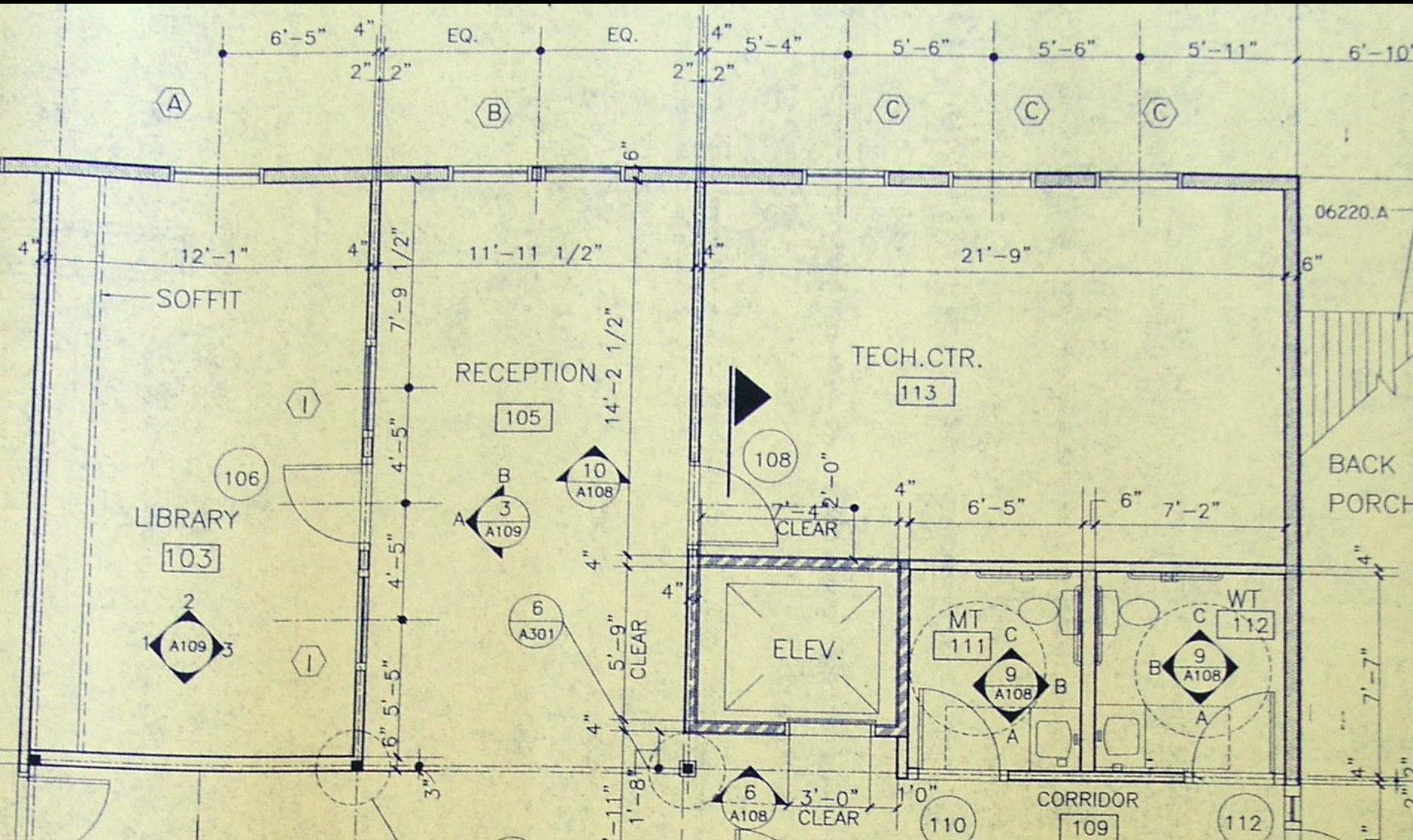



Receptionist's Desk



Receptionist's Desk

STATE OF NEW JERSEY
PINELANDS COMMISSION
RICHARD J. SULLIVAN CENTER
FOR
ENVIRONMENTAL POLICY AND EDUCATION
Donald T. DiPasquale
Acting Governor
Jerrold L. Jacobs
Chairman
Alexander M. Borbonick
Executive Director
Lorraine K. Grayson
Assistant Executive Director
B'Asses Conservation, Inc.
General Counsel
Pinelands Commission
2001
Sponsored by:
Hewlett-Packard
Chambers Club II
Pablo Torres Shores & Spa

WELCOME TO THE
PINELANDS COMMISSION



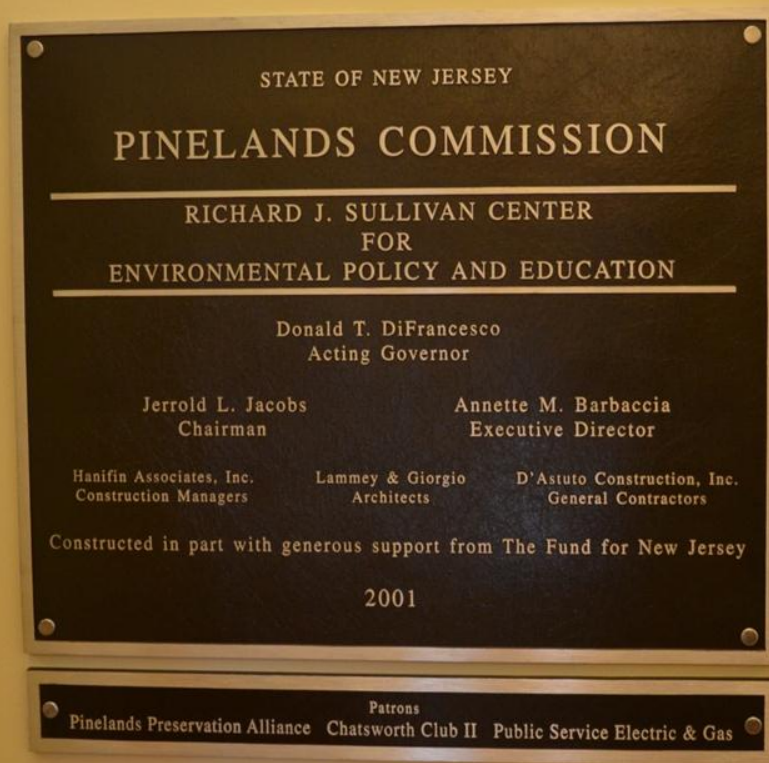

Founder's plaque
(to be moved)



**Site of new reception
window**

Site of new reception
window

New site of founder's
plaque (below)



Site of new TV/monitor



Site of new recreation map

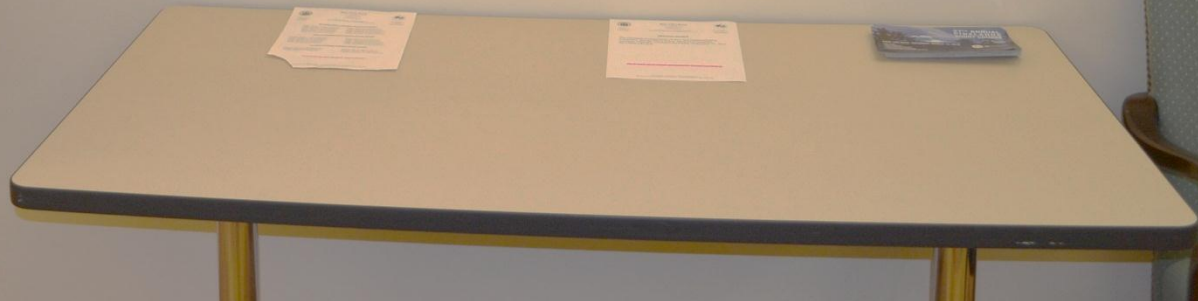

**Existing Library Wall –
Windows to be removed,
door to be moved**



Library wall



Entrance to Copy Room, site of new exhibit room (entrance to be widened)



106
TECHNICAL
CENTER



Site of new exhibit room



New exhibit room – north wall



New exhibit room – east wall







